

# 32 COOPER SQUARE

3,152 RSF | Entire 3rd Floor

FOR MORE INFORMATION, PLEASE CONTACT:

**Gregory Gang**

Executive Managing Director & Principal  
ggang@lee-associates.com  
M 646.662.3546

**Stephanie Moore**

Senior Director  
smoore@lee-associates.com  
M 347.824.9872

**Catherine O'Toole**

Executive Managing Director & Principal  
cotoole@lee-associates.com  
M 212.961.6252

**LEE &  
ASSOCIATES**  
COMMERCIAL REAL ESTATE SERVICES

All information supplied is from sources deemed reliable and is furnished subject to errors, omissions, modifications, removal of the listing for sale or lease, and to any listing conditions, including the rates and manner of payment of commissions for particular offerings imposed by principals or agreed by this Company, the terms of which are available to principals or duly licensed brokers. Any square footage dimensions set forth are approximate.

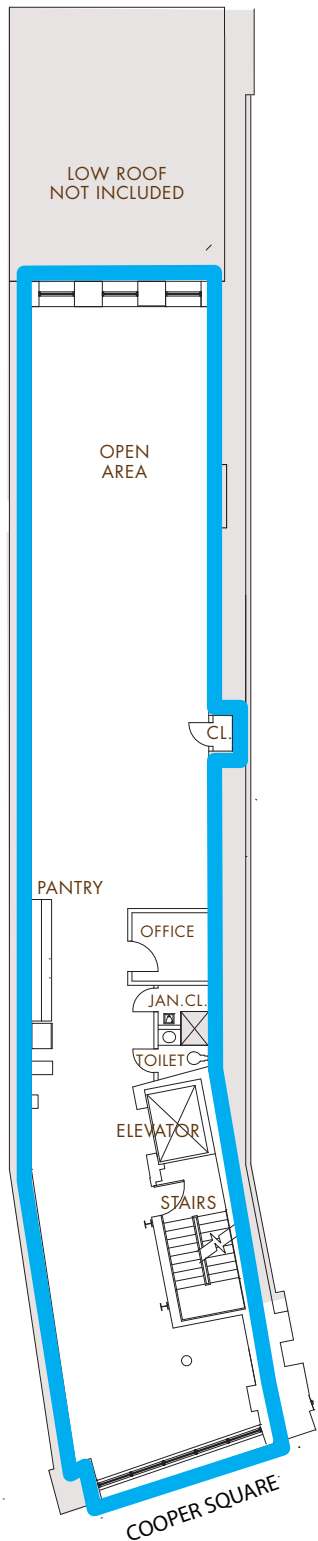

## SPACE

Entire 3rd Floor – 3,152 RSF

## BASE RENTAL

Upon request

## POSSESSION

2/15/19

## TERM

5 to 10 years

## DESCRIPTION

- Move in condition
- Wood floors throughout
- 9'-7" open ceilings
- Front and rear windows



# 32 COOPER SQUARE

3,152 RSF | Entire 3rd Floor

FOR MORE INFORMATION, PLEASE CONTACT:

### Gregory Gang

Executive Managing Director & Principal  
ggang@lee-associates.com  
M 646.662.3546

### Stephanie Moore

Senior Director  
smoore@lee-associates.com  
M 347.824.9872

### Catherine O'Toole

Executive Managing Director & Principal  
cotoole@lee-associates.com  
M 212.961.6252



All information supplied is from sources deemed reliable and is furnished subject to errors, omissions, modifications, removal of the listing for sale or lease, and to any listing conditions, including the rates and manner of payment of commissions for particular offerings imposed by principals or agreed by this Company, the terms of which are available to principals or duly licensed brokers. Any square footage dimensions set forth are approximate.



# 32 COOPER SQUARE

3,152 RSF | Entire 3rd Floor

FOR MORE INFORMATION, PLEASE CONTACT:

**Gregory Gang**

Executive Managing Director & Principal  
ggang@lee-associates.com  
M 646.662.3546

**Stephanie Moore**

Senior Director  
smoore@lee-associates.com  
M 347.824.9872

**Catherine O'Toole**

Executive Managing Director & Principal  
cotoole@lee-associates.com  
M 212.961.6252



All information supplied is from sources deemed reliable and is furnished subject to errors, omissions, modifications, removal of the listing for sale or lease, and to any listing conditions, including the rates and manner of payment of commissions for particular offerings imposed by principals or agreed by this Company, the terms of which are available to principals or duly licensed brokers. Any square footage dimensions set forth are approximate.